

RECORD OF SURVEY MAP No. 16501

SHEET 4 OF 7 SHEETS

NETWORK DETAILS AND TIES TO LOCAL CADASTRAL POINTS

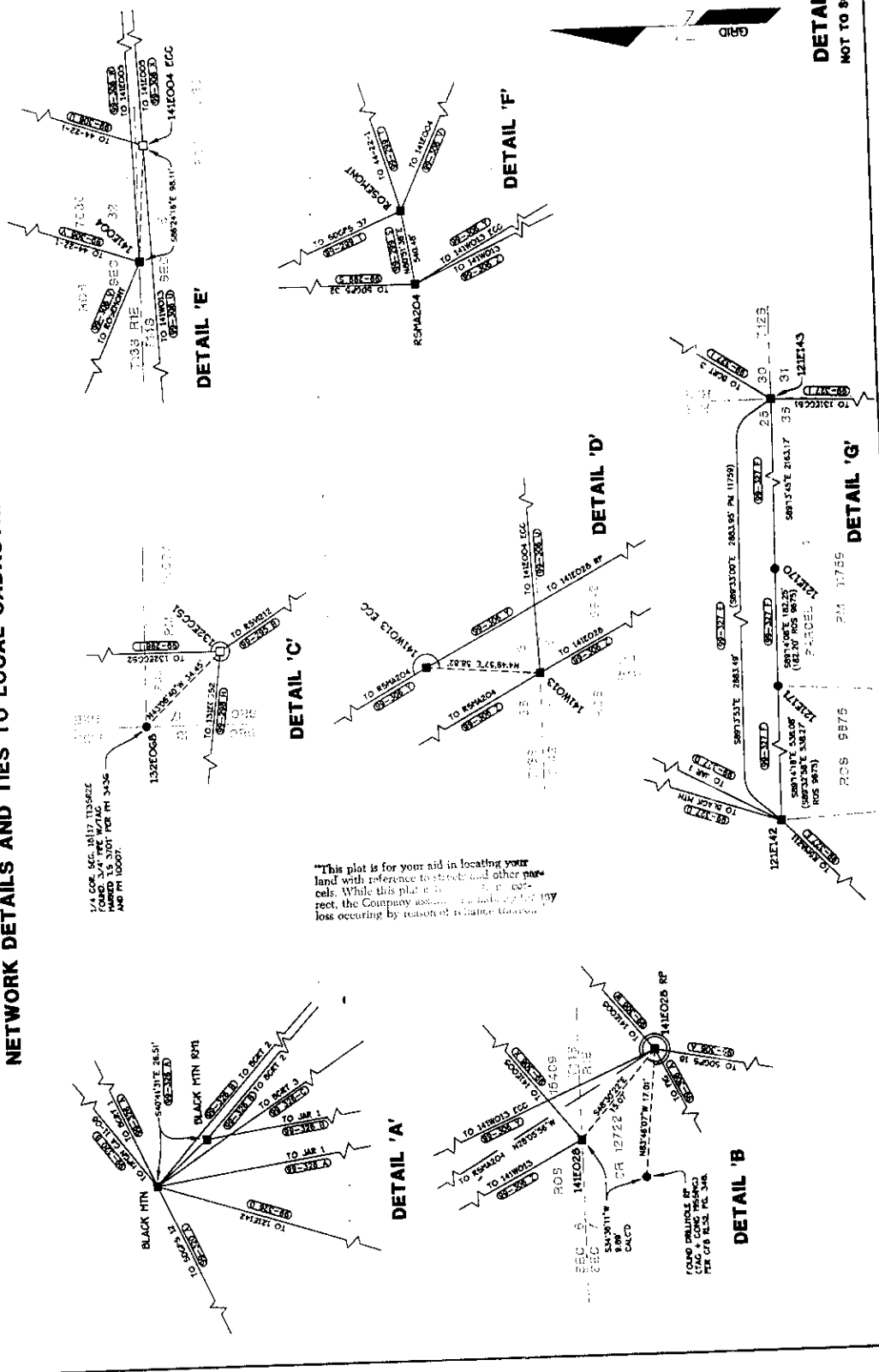

"This plot is for your aid in locating your land with reference to streets and other parcels. While this plot is for your aid, the Company assumes no liability for any loss occurring by reason of reliance thereon."

1/4 COR. SEC. 1617 T33S2E
 FOUND. 1.6 3.007 FOR PT 3436
 AND PT 10007.

TOPO. POINTS BY
 G. M. W. B. C. S. 1880
 FOR G. M. W. B. C. S. 1880

RECORD OF SURVEY MAP No. 16501

SHEET 5 OF 7 SHEETS

NETWORK DETAILS AND TIES TO LOCAL CADASTRAL POINTS

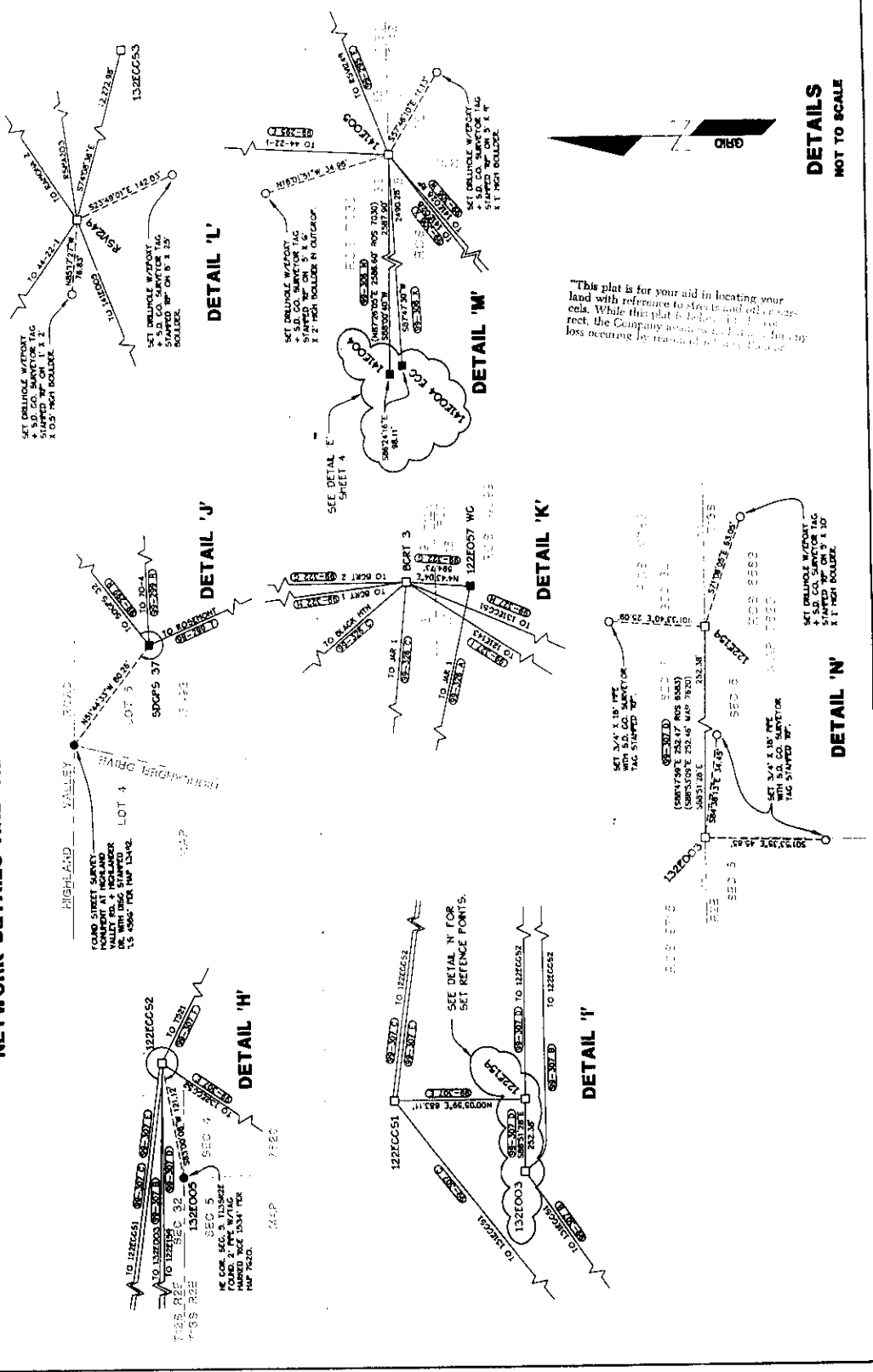

DETAILS
NOT TO SCALE

RECORD OF SURVEY MAP No. 16501

MONUMENT LOCATIONS & DESCRIPTIONS

16501

SHEET 7 OF 7 SHEETS

<p>122E170</p>	<p>LOCATION: SPLIT OF SUTHERLAND CANTON ROAD AND ALSO LANE. GO NELY ALONG CANTON ROAD (SPLIT) TO THE INTERSECTION WITH FOREST ROAD. APPROXIMATELY 132' ELY FROM CENTER OF THE ROAD. (SEE SURVEYOR'S NOTE #3)</p> <p>DESCRIPTION: FOUND 2" PPE WITH BUREAU OF LAND SURVEYING NOTES OF THE DEPARTMENT OF PUBLICITY OF A PORTION OF THE SUBDIVISION LINES OF TIGERIE TRACT 1962.</p>	<p>141W019</p>	<p>LOCATION: NELY OF RAMONA FROM THE INTERSECTION OF RAMONA TRAILS TO SANCTUARY DRIVE. FOLLOW RAMONA TRAILS TO SANCTUARY DRIVE. TURN RIGHT AND FOLLOW TO LOCATED POINT. LEFT AND FOLLOW ROAD TO LOCATED GATE. CONTINUE THROUGH GATE AND FOLLOW DIRT ROAD FROM JUNCTION OF SAILED WIRE FENCE. USE FROM JUNCTION OF SAILED WIRE FENCE. (SEE SURVEYOR'S NOTE #3)</p> <p>DESCRIPTION: FOUND 2" PPE AND SAN DIEGO COUNTY ENGINEER TAG PER 625 1942 SHEET 5 - 1942 SHEET 6.</p>
<p>122E171</p>	<p>LOCATION: SPLIT OF SUTHERLAND CANTON ROAD FROM THE INTERSECTION OF BLACK CANYON ROAD (SPLIT) TO THE INTERSECTION WITH FOREST ROAD. APPROXIMATELY 132' ELY FROM CENTER OF THE ROAD. (SEE SURVEYOR'S NOTE #3)</p> <p>DESCRIPTION: FOUND 2" PPE WITH BUREAU OF LAND SURVEYING NOTES OF THE DEPARTMENT OF PUBLICITY OF A PORTION OF THE SUBDIVISION LINES OF TIGERIE TRACT 1962.</p>	<p>141W018 ECC</p>	<p>LOCATION: SEE LOCATION FOR 141W019 (1113511) (SEE SURVEYOR'S NOTE #3)</p> <p>DESCRIPTION: FOUND 2" PPE AND SAN DIEGO COUNTY ENGINEER TAG PER 625 1942 SHEET 5 - 1942 SHEET 6.</p>
<p>122ECC01</p>	<p>LOCATION: NELY OF RAMONA FROM THE INTERSECTION OF RAMONA TRAILS TO SANCTUARY DRIVE. FOLLOW RAMONA TRAILS TO SANCTUARY DRIVE. TURN RIGHT AND FOLLOW TO LOCATED POINT. LEFT AND FOLLOW ROAD TO LOCATED GATE. CONTINUE THROUGH GATE AND FOLLOW DIRT ROAD FROM JUNCTION OF SAILED WIRE FENCE. USE FROM JUNCTION OF SAILED WIRE FENCE. (SEE SURVEYOR'S NOTE #3)</p> <p>DESCRIPTION: FOUND 2" PPE AND SAN DIEGO COUNTY ENGINEER TAG PER 625 1942 SHEET 5 - 1942 SHEET 6.</p>	<p>141W018 ECC</p>	<p>LOCATION: SEE LOCATION FOR 141W019 (1113511) (SEE SURVEYOR'S NOTE #3)</p> <p>DESCRIPTION: FOUND 2" PPE AND SAN DIEGO COUNTY ENGINEER TAG PER 625 1942 SHEET 5 - 1942 SHEET 6.</p>
<p>122ECC02</p>	<p>LOCATION: SPLIT OF SUTHERLAND CANTON ROAD FROM THE INTERSECTION OF BLACK CANYON ROAD (SPLIT) TO THE INTERSECTION WITH FOREST ROAD. APPROXIMATELY 132' ELY FROM CENTER OF THE ROAD. (SEE SURVEYOR'S NOTE #3)</p> <p>DESCRIPTION: FOUND 2" PPE WITH BUREAU OF LAND SURVEYING NOTES OF THE DEPARTMENT OF PUBLICITY OF A PORTION OF THE SUBDIVISION LINES OF TIGERIE TRACT 1962.</p>	<p>141W018 ECC</p>	<p>LOCATION: SEE LOCATION FOR 141W019 (1113511) (SEE SURVEYOR'S NOTE #3)</p> <p>DESCRIPTION: FOUND 2" PPE AND SAN DIEGO COUNTY ENGINEER TAG PER 625 1942 SHEET 5 - 1942 SHEET 6.</p>
<p>122ECC03</p>	<p>LOCATION: SPLIT OF SUTHERLAND CANTON ROAD FROM THE INTERSECTION OF BLACK CANYON ROAD (SPLIT) TO THE INTERSECTION WITH FOREST ROAD. APPROXIMATELY 132' ELY FROM CENTER OF THE ROAD. (SEE SURVEYOR'S NOTE #3)</p> <p>DESCRIPTION: FOUND 2" PPE WITH BUREAU OF LAND SURVEYING NOTES OF THE DEPARTMENT OF PUBLICITY OF A PORTION OF THE SUBDIVISION LINES OF TIGERIE TRACT 1962.</p>	<p>141W018 ECC</p>	<p>LOCATION: SEE LOCATION FOR 141W019 (1113511) (SEE SURVEYOR'S NOTE #3)</p> <p>DESCRIPTION: FOUND 2" PPE AND SAN DIEGO COUNTY ENGINEER TAG PER 625 1942 SHEET 5 - 1942 SHEET 6.</p>
<p>122ECC04</p>	<p>LOCATION: SPLIT OF SUTHERLAND CANTON ROAD FROM THE INTERSECTION OF BLACK CANYON ROAD (SPLIT) TO THE INTERSECTION WITH FOREST ROAD. APPROXIMATELY 132' ELY FROM CENTER OF THE ROAD. (SEE SURVEYOR'S NOTE #3)</p> <p>DESCRIPTION: FOUND 2" PPE WITH BUREAU OF LAND SURVEYING NOTES OF THE DEPARTMENT OF PUBLICITY OF A PORTION OF THE SUBDIVISION LINES OF TIGERIE TRACT 1962.</p>	<p>141W018 ECC</p>	<p>LOCATION: SEE LOCATION FOR 141W019 (1113511) (SEE SURVEYOR'S NOTE #3)</p> <p>DESCRIPTION: FOUND 2" PPE AND SAN DIEGO COUNTY ENGINEER TAG PER 625 1942 SHEET 5 - 1942 SHEET 6.</p>

COORDINATE COMPARISON

A COMPARISON OF CROSS COORDINATES TO BE LISTED ON THE TOWNSHIP 13 SOUTH RANGE 1 WEST REDEMPTION SURVEY SEE SURVEYOR'S NOTE NO. 4

STATION NAME	EASTING	NORTHING	DIFFERENCE
FIG 1 (113511)	193813.518	6345408.458	-0.011
FIG 2 (113511)	193813.528	6345408.479	-0.011
RAMONA 2 (113511)	1933159.109	5384449.058	-0.018
131W021 (113511)	1968296.903	6352270.726	-0.003
131W021 (113511)	1968296.793	6352270.721	-0.005
44-22-1	1950290.375	6364958.647	-0.010
44-22-1	1950290.380	6364959.380	-0.003
44-22-1	1950290.380	6364959.380	-0.003

This plat is for your aid in locating your land with reference to stakes and other points. It is not to be used for any other purpose.